



BESS

BRITISH ELBOW & SHOULDER SOCIETY

*The annual BESS meeting
is the premier upper limb
forum in the UK*

Exhibition & Educational Support Opportunities



**20th ANNUAL
SCIENTIFIC MEETING
LONDON 2009**

UCL

Wednesday 24th –
Friday 26th June



***New for 2009 –
Saturday 27th June
Instructional Course:
'Neuropathology
of the Shoulder'***

Excellence Through Knowledge



The organisers of BESS 2009 hope to welcome old friends from our Industry to join us in London and we hope to attract new partners who will see the benefit of showing their products to the largest annual gathering of shoulder and elbow healthcare professionals in the UK.

Who benefited from attending last year?

Acumed, Arthrex, Arthrocare UK, Biomet UK, Blackwell UK, Con-Med Linvatec, DePuy Mitek, DePuy UK, DJO UK, Europa Medical, Exactech (UK), Finsbury Orthopaedics, Genzyme, Karl Storz, Mathys Orthopaedics, Med Spirit, Neuro-Technics, Northstar Orthopaedics, Olympus Keymed, Orthopaedic Implants, Orthosonics, Orthoview, Osteotec, Private Healthcare UK, Smith & Nephew, Spectrum Technology, Stryker UK, Surgicraft, Synthes, TRB Chemedica UK, Trustech, Zimmer



For 2009, the BESS Members Dinner has been combined with the Conference Dinner forming the BESS Society and Conference Dinner which will take place at the Imperial War Museum on Thursday 25th June, 2009. Companies wishing to

participate in the Society's Main Event will be required to purchase one of the Educational Support Opportunities available at this year's meeting.



BESS 2009 would like to encourage industry access to the delegates on the evening of Wednesday 24th June for their own networking opportunities.

New for 2009 – Saturday 27th June

2009

Instructional Course: 'Neuropathology of the Shoulder'

This meeting will be supported by its own exhibition and discounted rates are offered to our industry partners who wish to also participate in both meetings.



Enhancing Educational Opportunities to BESS members

We would be delighted if our industry partners support the Educational Support Opportunities available at this year's meeting

The Society greatly appreciates the ongoing support it receives from its industry partners. To become compliant with current regulations we have revised our sponsorship arrangements and are introducing Educational Support opportunities to suit three levels of expenditure.

We believe the new arrangements offer a more professional and transparent basis for our partners and will also provide greater opportunities for acknowledgement and assist planning both for the conference organisers and for our partners.

Should you have any suggestions for Educational Support, outside of these packages, we would welcome these for consideration by the BESS 2009 Committee.



PLATINUM

Platinum support is the highest form of recognition and is available to our partners who contribute £10,000.00 for this year's meeting. Platinum partners will receive:

- Display site for your own pop-up banner in the main plenary room
- Platinum Partner acknowledgement projected during the AV displays
- Distribution of educational material, i.e., CD, company brochure, memory stick, in the delegate bags
- Full Page Advert in the final Conference Programme
- Reserved premium Exhibition site
- Option to increase their Exhibition site by a further 3m x 2m area, i.e. total stand size 6m x 2m.
- Attendance for 4 company personnel at the BESS Main Event

Platinum partners will be give first opportunity to provide E-Poster Room and/or internet café, at cost.



GOLD

Gold will be awarded to our partners who contribute £5,000.00 for this year's meeting. Gold partners will receive:

- Gold Partner acknowledgement projected during the AV displays
- Distribution of educational material, i.e., CD, company brochure, memory stick, in the delegate bags
- Full colour logo in the final Conference Programme
- Attendance for 2 company personnel at the BESS Main Event



SILVER

Silver will be awarded to our partners who contribute £2,500.00 for this year's meeting. Silver partners will receive:

- Distribution of educational material, i.e., CD, company brochure, memory stick, in the delegate bags
- Full colour logo in the final Conference Programme
- Attendance for 1 company personnel at the BESS Main Event

UNRESTRICTED EDUCATIONAL GRANTS £1,250.00 inc. refreshments

This year the BESS 2009 organising committee have pre-arranged four instructional courses 8.00am – 9.00am on Thursday to be repeated on Friday aimed at 20 delegates per course. Unrestricted Educational Grants will allow our industry partners to provide and display their own equipment for these courses and acknowledgement will be made in the final Conference Programme.

Should you wish to participate in any of the Educational Support opportunities at this meeting please telephone Sovereign Conference (Tel: + 44 (0)1527 518777).

EXHIBITION

The Exhibition will be held in the Jeremy Bentham Room and North and South Cloisters at the UCL and will be open during Registration on Wednesday 24th June 2009 and will close after lunch on Friday 26th June 2009. Delegates will be invited to meet the Exhibitors in the exhibition area where refreshments and lunches will be served.

BESS Conference Exhibition Package @ £2,250.00 to include:

- Exhibiting on 3 days: Wednesday 24th, Thursday 25th and Friday 26th
- 3m x 2m open taped area
- Two exhibitor passes per day which includes refreshments, lunch and access to the scientific sessions
- Company details listed in the Programme

BESS Instructional Course Exhibition Package @ £750.00 to include:**

- Exhibiting on Saturday 27th June, 2009 (set-up 3.00 pm – 5.00 pm on Friday 26th)
- 3m x 2m open taped area
- Two exhibitor passes per day which includes refreshments, lunch and access to the scientific sessions

** Discount of £250.00 to BESS Conference Exhibitors



Details will also be available
on the BESS website:

www.bess.org.uk

Conference Organisers:

Sovereign Conference, Secure Hold Business Centre,
Studley Road, Redditch, Worcestershire B98 7LG, England
Tel: +44(0) 1527 518777 Fax: +44(0) 1527 518718
Email: exhibitions@sovereignconference.co.uk

All exhibition stands will be a 3m x 2m area so even the smallest companies will have direct access to the delegates.

Platinum Partners will have the opportunity to increase their stand space by a further 3m x 2m area and will have the opportunity to select one of the premium sited spaces, as per the shaded areas shown on the plans.

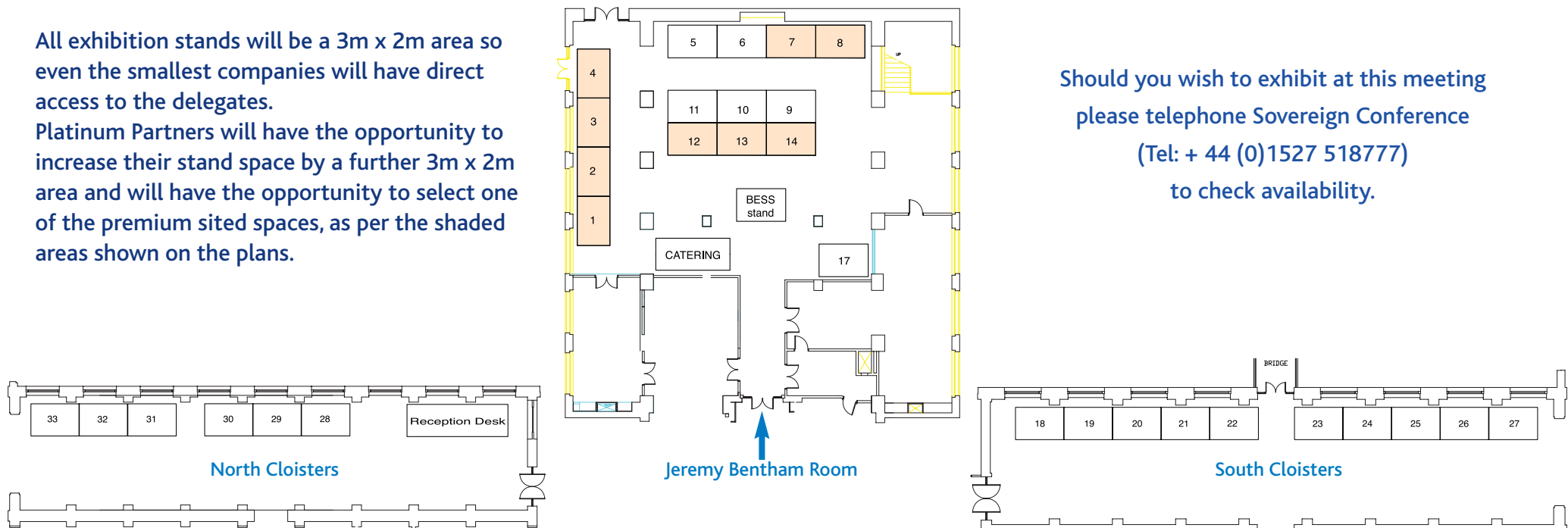

Should you wish to exhibit at this meeting
please telephone Sovereign Conference
(Tel: + 44 (0)1527 518777)
to check availability.